

# Substantial savings from small to large production runs

Tool life according to cutting speed

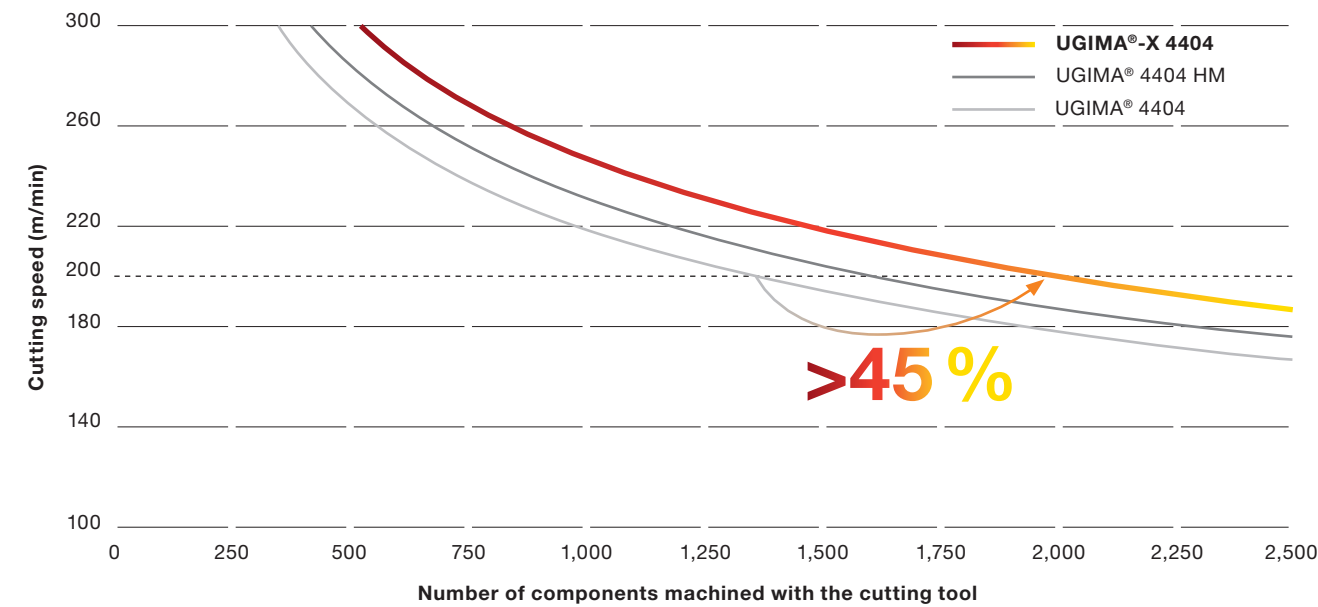

UGIMA®-X:  
**+15 %** productivity

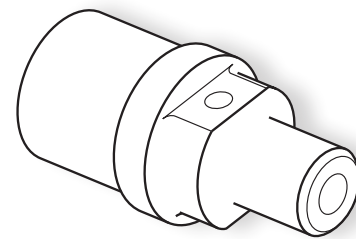

Case Study

	UGIMA® 4305	UGIMA®-X 4305
Material cost per component (€)	0.89	0.91
Cycle time / component (second)	65	56
Productivity (component/hour)	55.4	64.3
Machining cost (€/component)	0.81	0.70
Tooling cost (€/component)	0.06	0.06
Total component cost (€)	1.76	1.67
Savings per component (€)		0.09
Duration of the production run in days	0.75	0.65
Savings in €/kg		0.48

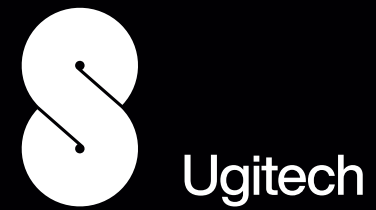

**Ugitech SA**  
France  
Avenue Paul Girod  
CS90100  
73403 UGINE Cedex  
Tel.: + 33 (0)4 79 89 30 30  
Fax: + 33 (0)4 79 89 34 34  
barsales@ugitech.com

www.ugitech.com

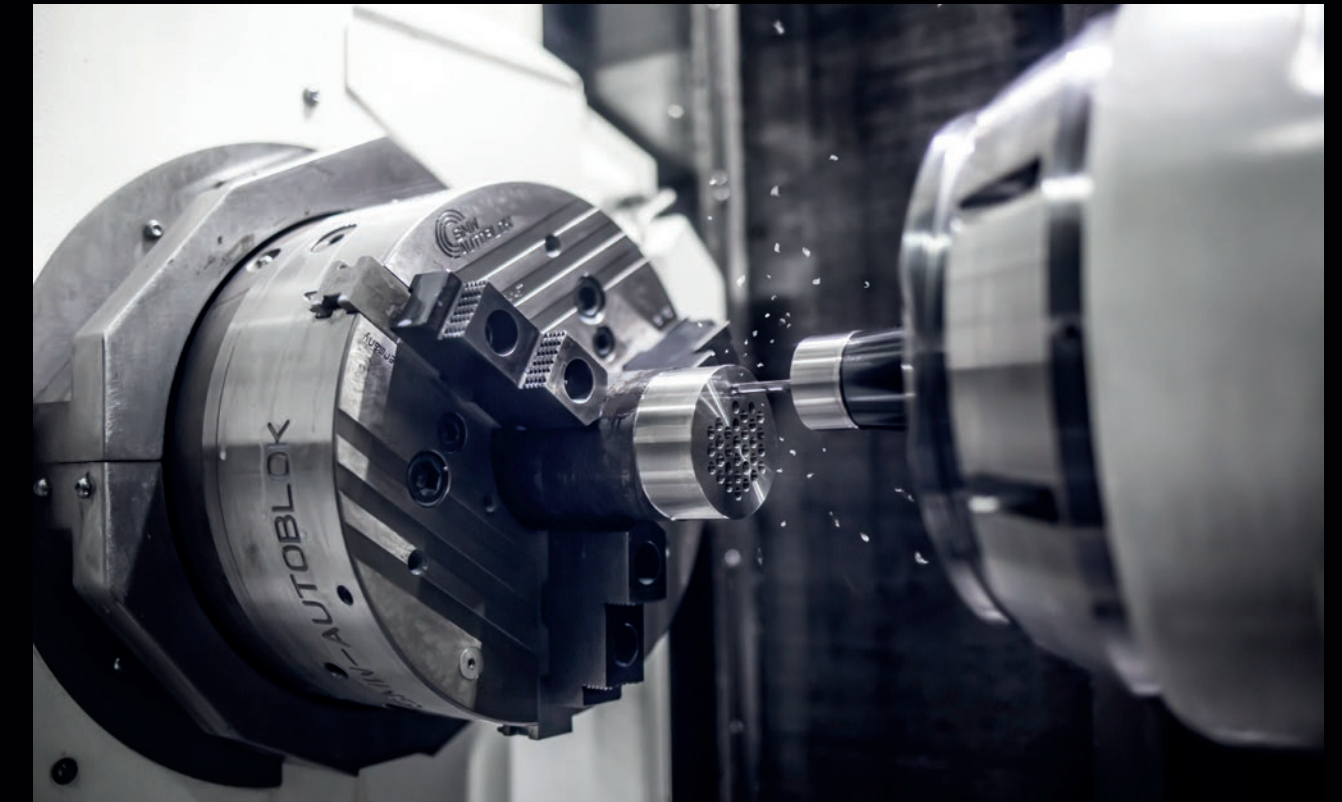

# UGIMA®-X

Unrivalled machinability  
for peace of mind

The information and data presented here in are typical or average values and are not a guarantee of maximum or minimum values. Only the information reported on our material certificates is to be considered as relevant. Applications specifically suggested for material described herein are made for the purpose of illustration only to enable the reader to make its own evaluation and are not intended as warranties, either express or implied, of fitness for any purposes.



Villi® - www.imprimerie-villiere.com  
Thuria - UGIMA®-X\_EN - 07-2021  
D15150EN

UGIMA®-X:

# UGIMA® 3<sup>rd</sup> generation

## You enjoy unrivalled performance

- Productivity increases of 10 to 20% compared to UGIMA® grades
- Optimized cycle time
- Longer tool service life
- Improved chip breakability

## You can improve your process reliability

- Performance reproducibility from one batch to another.
- UGIMA® 4.0 automated process control.
- Component cost reliability.

## 3 UGIMA®-X grades

### UGIMA®-X 4404

**+ 20 %** productivity increases compared to UGIMA® 4404 and higher than UGIMA® 4404 HM

### UGIMA®-X 4305

**+ 15 %** productivity increases compared to UGIMA® 4305 and higher than UGIMA® 4305 HM.  
Better corrosion resistance, less risk of cracking and suitable for thin-walled parts.

### UGIMA®-X 4307

**+ 10 %** productivity increases compared to UGIMA® 4307 and suitable for thin-walled parts.

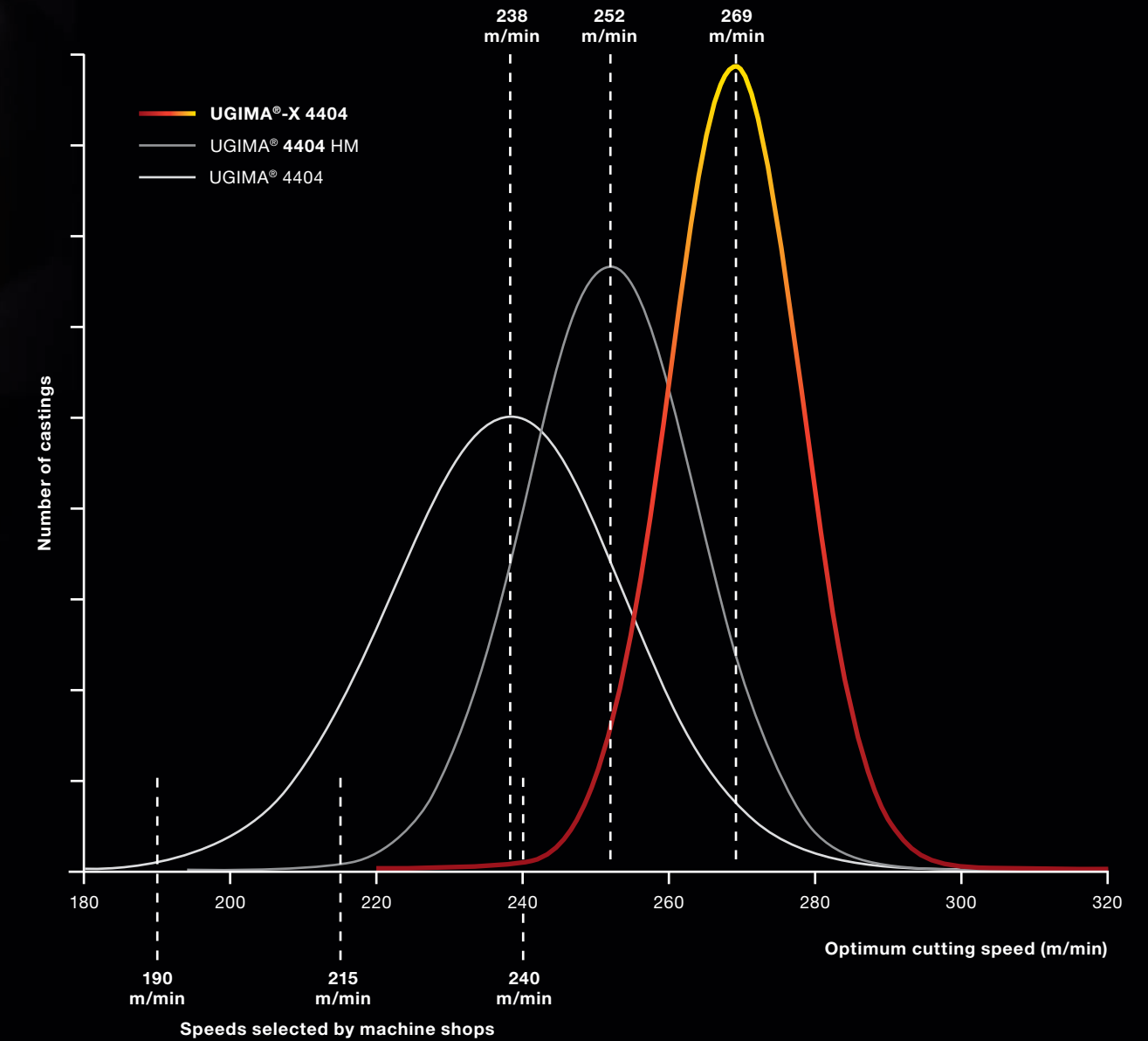

- 30 years of Technical Assistance
- 3 years of development work
- 2,000 tons of products produced
- 3,000 hours of tests
- 50 tons of chips